

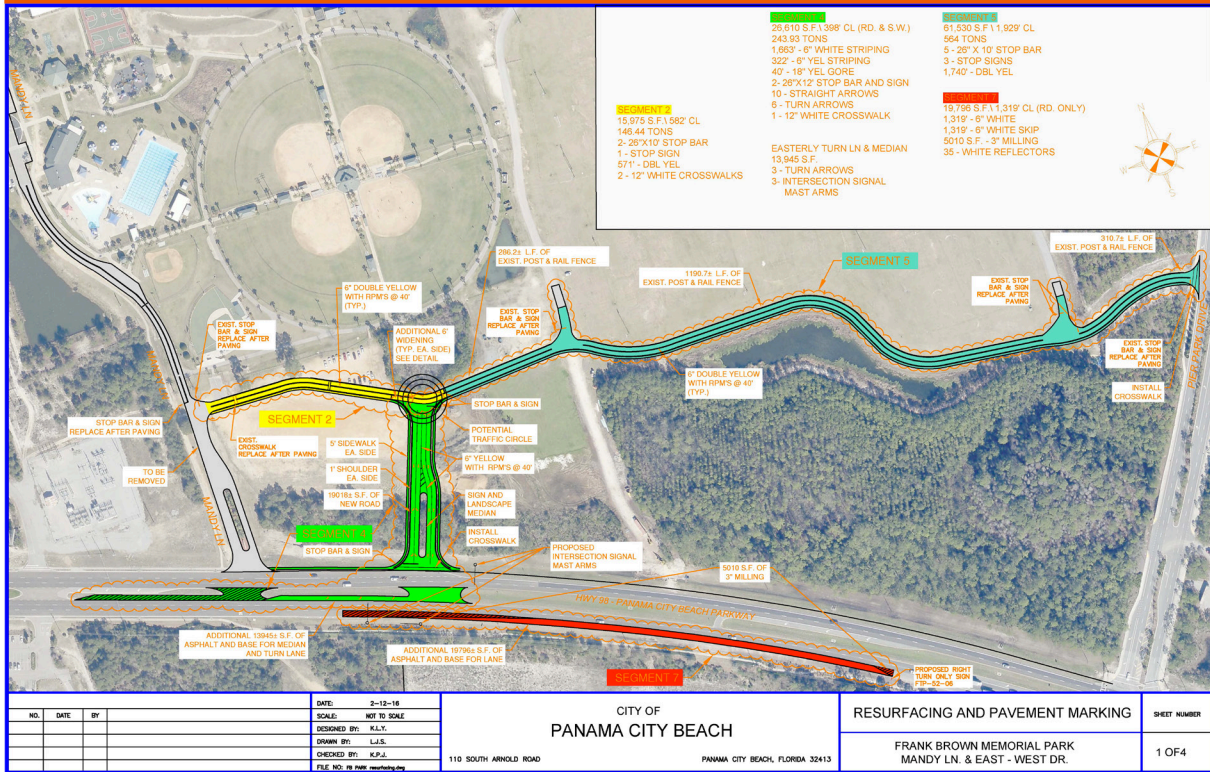

# Capacity Improvement

## FRANK BROWN PARK ENTRANCE & ROAD IMPROVEMENTS



### SOLUTION

The purpose of this project is to relocate the entrance to Frank Brown Park and improve internal roads. Some of the improvements include locating/replacing wheel stops, signage, pavement markings, roadway resurfacing and a potential interior traffic circle. Additionally a signal is proposed for the new intersection with PCB Parkway. A major benefit of this project would be safety for tourists and residents. The relocation and redesign of the entrance and roadway repairs will improve flow and safety adding to an overall improvement to a major tourist destination in the County. The improvements and roadway resurfacing will help eliminate confusion and increase accessibility throughout the park.

### PROBLEM

The current entrance creates a dangerous intersection with PCB Parkway and is prone to congestion. Several internal roads are in need of repair and resurfacing.

**HALF CENT SALES TAX**  
 BAY COUNTY & MUNICIPALITIES

